

LEGEND	
	U.S. GAS LINE
	U.S. WATER LINE
	U.S. ELEC. LINE
	EXISTING GRADING
	PROPOSED GRADING
	PROPOSED ELEVATION
	CURB INLET DRAIN
	OPEN COVER MH
	SOLID COVER MH
	STORM POOL
	DISTRIBUTION POOL
	DISTRIBUTION CHAMBER
	LEACHING POOL
	GREASE TRAP
	SAND + GRIT INTERCEPTOR
	STORM POOL
	50% SANITARY EXPANSION
	HANDICAP PARKING SPACE
	OVERHEAD DOOR
	UTILITY POLE

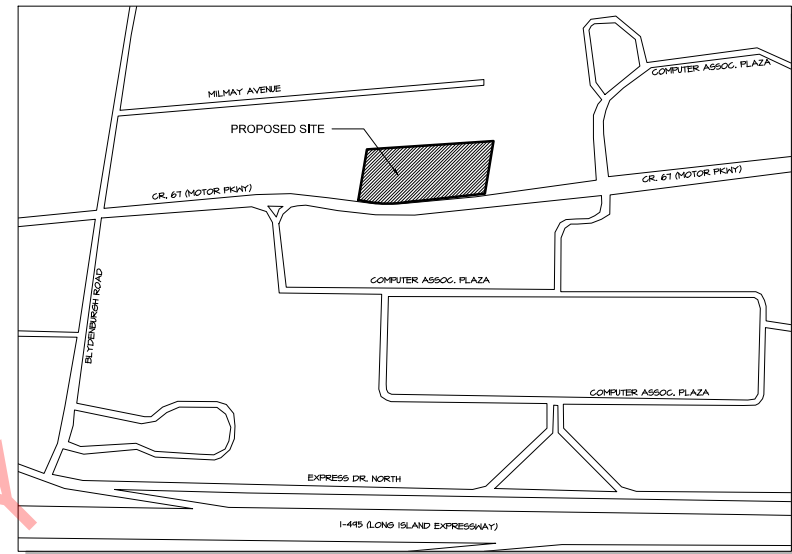

KEY MAP  
SCALE: 1" = 400'

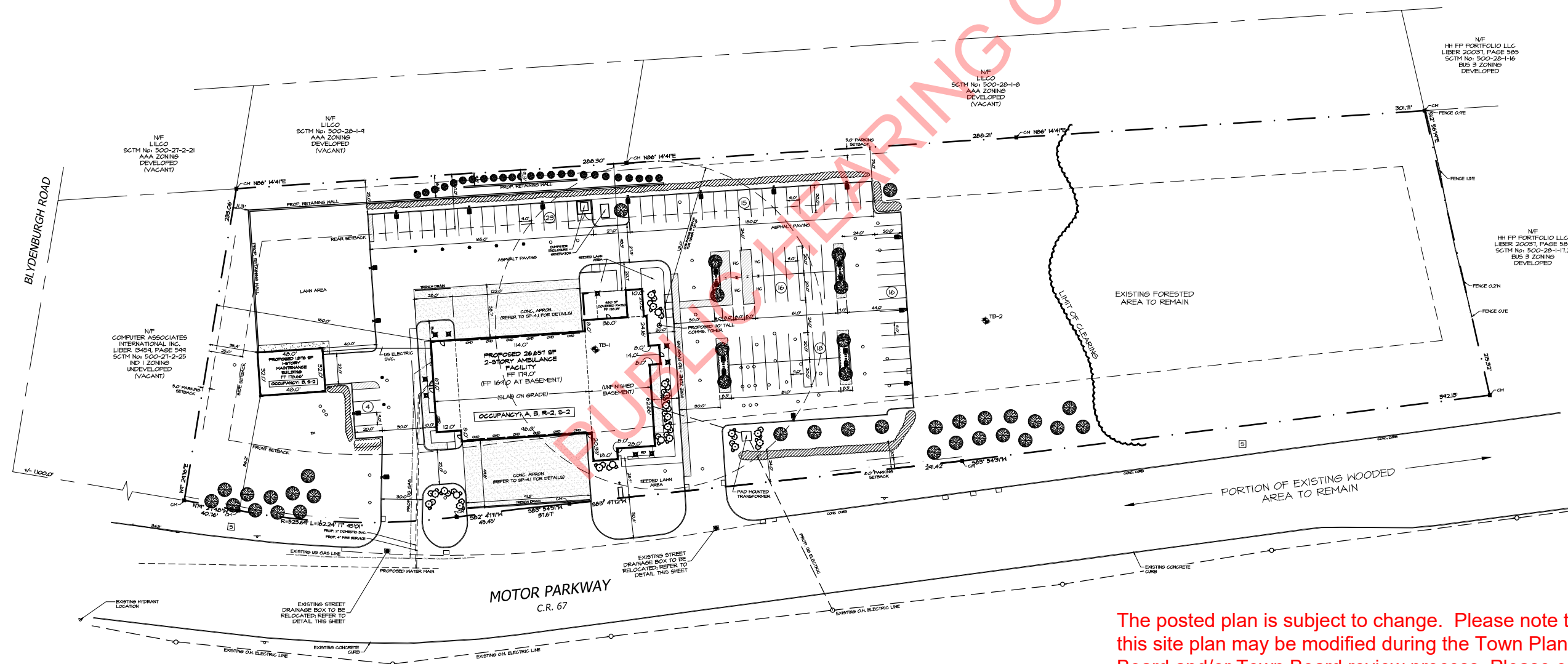

**PROPOSED SITE PLAN**

SCALE: 1" = 40'  
SCTM #: 0500-28-01-10, 11, 12

NOTES:  
1. THIS PLAN REFERENCES A SURVEY BY VHB, P.C. DATED APRIL 28TH, 2023

The posted plan is subject to change. Please note that this site plan may be modified during the Town Planning Board and/or Town Board review process. Please contact the assigned planning department staff member if you have questions regarding the date and status of any posted graphics.

DATE	ISSUED
01-26-2024	SUBMITTED FOR SITE PLAN APPROVAL
04-14-2024	DRAWING SET UPDATED FOR SUBMISSION

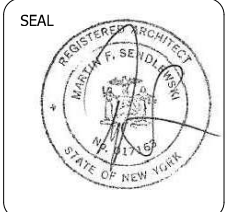

**SENIEWSKI ARCHITECTS, P.C.**  
ARCHITECTS - PLANNERS  
215 ROANOKE AVENUE  
RIVERHEAD, NY 11901  
(631) 727-5352

PROPOSED AMBULANCE FACILITY  
CENTRAL ISLIP-HAUPPAGUE V.A.C.  
MOTOR PARKWAY, HAUPPAGUE, NY 11788  
SITE DEVELOPMENT PLAN  
SCTM #: 0500-28-01-10, 11, 12

PROJECT No. 2203

CHECKED BY:

DRAWING:

SP-1