

PROPERTY OWNER / APPLICANT

J&J CORRADO REAL ESTATE LLC
10 MOFFITT BLVD
BAY SHORE, NEW YORK 11706
ATTN: JOHN CORRADO
(631) 665-3245

KEY MAP

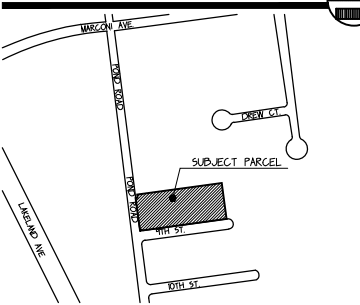

SITE DATA (W/ 9TH STREET ABANDONMENT)

AREA OF SITE	2.74 ACRES (119,477 SQ.FT.)
ZONING	INDUSTRIAL TRANSITIONAL DISTRICT
INTENDED USE	BUS PARKING + DISPATCH FACILITY
BUILDING AREA	2,390 SQ.FT.
(INCLUDING OVERHANGS)	F.A.R. (20%)
PAVING AREA	83,410 SQ.FT. (69.8%)
TOTAL LANDSCAPE AREA	33,677 SQ.FT. (28.2%)
FRONT YARD LANDSCAPE AREA	16,335 SQ.FT. (13.7%)

PARKING

PARKING REQUIRED	
OFFICE = 2,390 SQ.FT. / 200 =	12 SPACES
PARKING REQUIRED =	12 SPACES
PARKING PROVIDED =	208 SPACES
(82 CARS, 126 VANS)	
(INCLUDING 6 H.C. SPACES)	

The posted plan is subject to change. Please note that this site plan may be modified during the Town Planning Board and/or Town Board review process. Please contact the assigned planning department staff member if you have questions regarding the date and status of any posted graphics.

REVISION	DATE



STS POND AND 9TH
POND ROAD, RONKONKOMA, N.Y.
S.C.T.M.# 0500-105-02-125.3, 125.4, 125.2
GERMAN & CLEMENS ARCHITECTURE, P.C.
(SUCCESSOR FIRM TO GARY J. BRUNO ARCHITECT, P.C.)
3275 VETERANS MEMORIAL HWY., SUITE B-11, RONKONKOMA, N.Y. 11779
P 631 563-4848 GermanAndClemens@gmail.com

FILE NO. 2114
DATE 03/17/22
DRAWN DEC.
CHKD JLG.
SK7