

PARKING AREA

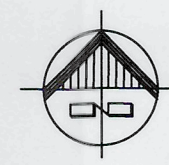
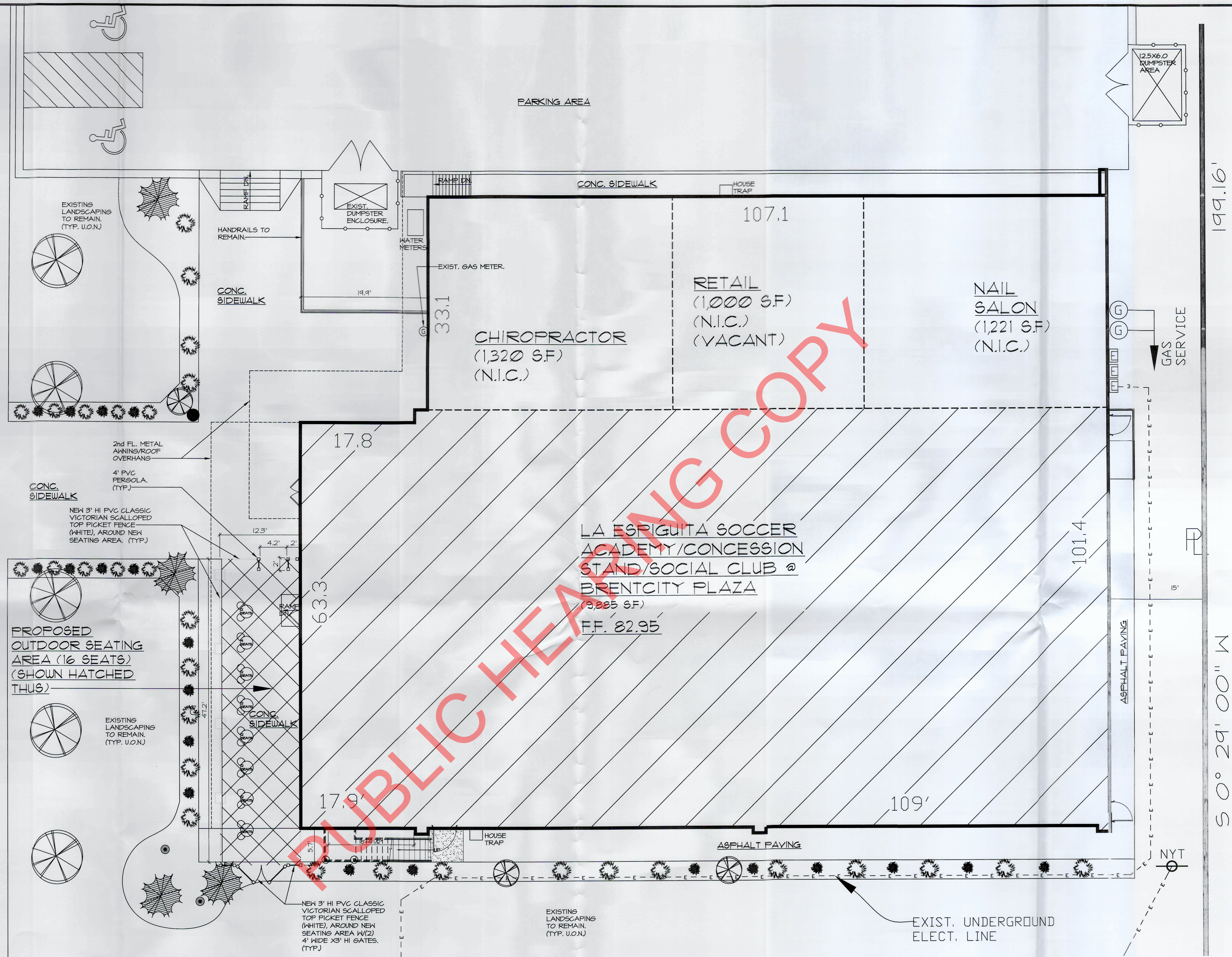

PARTIAL GROUND FLOOR PLAN

SCALE: 1/8" = 1'-0"

The posted plan is subject to change. Please note that this site plan may be modified during the Town Planning Board and/or Town Board review process. Please contact the assigned planning department staff member if you have questions regarding the date and status of any posted graphics.

JFT



ARCHITECTURAL  
DESIGNS

ARCHITECTURAL DRAFTING

PLANNING

INTERIOR DESIGN

1156 NAMDAC AVENUE

BAY SHORE, NY 11706

TEL: (631) 647-4467

FAX: (631) 647-4467

MOBILE: (631) 950-6698

E-MAIL: JFTARCH@AOL.COM

LUIGI CLAUDIO  
SCIANDRA

PROFESSIONAL ENGINEER

5 WESLEYAN COURT

SMITHTOWN, NY 11787-3011

TEL: (631) 543-2953

FAX: (631) 543-1526

EMAIL: lcs4d@aol.com



THESE DRAWINGS ARE AN INSTRUMENT OF  
SERVICE AND THE PROPERTY OF THE  
ENGINEER. INFRINGEMENTS WILL BE  
PROSECUTED.

### REVISIONS

NO.	DATE	DESCRIPTION
1	-	-
2	-	-
3	-	-
4	-	-
5	-	-
6	-	-

PROJECT TITLE  
**LA ESPIGUITA SOCCER  
ACADEMY/CONCESSION  
STAND EXTERIOR  
SEATING**

1795 BRENTWOOD RD.  
BRENTWOOD, NY 11717

TAX MAP #: 0500-137-4-18

DRAWING TITLE

PARTIAL GROUND  
FLOOR PLAN

DRAWN BY:

JFT

CHECKED BY:

LOS

DATE:

7-28-2021

SCALE:

AS SHOWN

DRAWING NO.

A-1

PROJECT NO.

2021-33