

PROPERTY OWNER

ROBERT MAZZOLI
9 LANDINGS LN.
EAST PATCHOGUE, N.Y. 11772

APPLICANT

ROBERT MAZZOLI
9 LANDINGS LN.
EAST PATCHOGUE, N.Y. 11772

SITE DATA

AREA OF SITE	0.399 ACRES (17,385 SQ.FT.)
EXISTING ZONING	INDUSTRIAL-1
USE	AUTO REPAIR + OUTDOOR OVERNIGHT PARKING OF REGISTERED VEHICLES
EXISTING BUILDING AREA	1,380 SQ.FT. (7.9%)
PAVING AREA	9,352 SQ.FT. (53.8%)
TOTAL LANDSCAPE AREA	
REQUIRED	3,477 SQ.FT. (20.0%)
PROVIDED	5,148 SQ.FT. (29.6%)
FRONT YARD LANDSCAPE AREA	
REQUIRED	1,739 SQ.FT. (10.0%)
PROVIDED	1,933 SQ.FT. (11.1%)
BUFFER AREA	1,506 SQ.FT. (8.7%)

KEY MAP

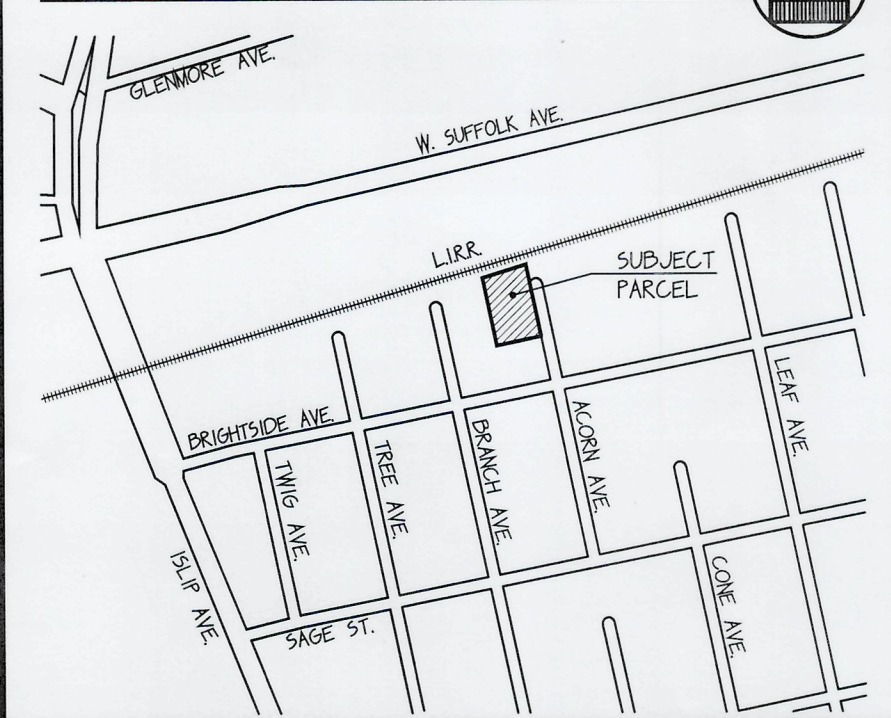

PARKING

PARKING REQUIRED	
AUTO REPAIR + 1,380 / 200 + 5 =	11.9 SPACES
PARKING REQUIRED =	12 SPACES
PARKING PROVIDED =	9 CAR SPACES 6 TRUCK SPACES (INCLUDING 1 H.C. SPACES)

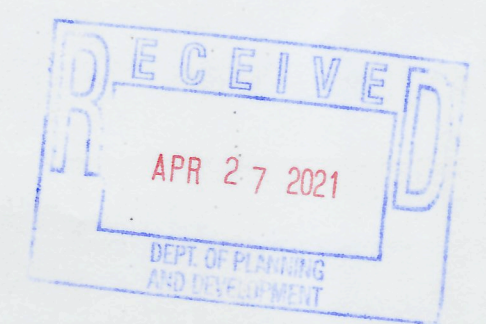

REVISION	DATE

The posted plan is subject to change. Please note that this site plan may be modified during the Town Planning Board and/or Town Board review process. Please contact the assigned planning department staff member if you have questions regarding the date and status of any posted graphics.



264 ACORN AVENUE
264 ACORN AVENUE, CENTRAL ISIP, NEW YORK 11772
S.C.T.M.# 0500-119-02-40
GERMAN & CLEMENS ARCHITECTURE, P.C.
(SUCCESSOR FIRM TO GARY J. BRUNO ARCHITECT, P.C.)
3275 VETERANS MEMORIAL HWY., SUITE B-11, RONKONKOMA, N.Y. 11779
P 631 563-4848 GermanAndClemens@gmail.com

FILE NO. 20063
DATE 02/25/21
DRAWN DEC.
CHKD JMC.
SK1D